

While the northern development area will initially be greened by expanding the adjacent nature reserve and only adding an information center for it, but in the future will also offer space for possible additional residential uses, the southern planning area will be upgraded through new buildings and adjustments to the existing structures and will become the new center of the Kurviertel. The focus is on the people, especially the islanders, for whom an inclusive neighborhood with new jobs, educational opportunities and meeting areas is to be created. The most important changes are the new Borkum Innovation Center ("Innovationszentrum Borkum"), the House of Education and the conversion of the Kulturinsel. In addition to the tourist information center, the Borkum Innovation Center includes co-working spaces, research facilities and work- and exhibition areas for start-ups, thus centrally providing new jobs and future prospects for the Borkum population. Through a conversion of the former tennis hall, the House of Education is planned in immediate proximity of the Innovation Center. Here, in the form of a kindergarten, an academy for the elderly and premises for a "Inselabitur" (online classes in cooperation with other North Sea islands), educational and day-care facilities are to be offered for islanders of all ages. The playground attached to the kindergarten should also be a meeting place for Borkum children outside its opening hours. Multigenerational Housing adds to a strongly connected population that integrates people of all ages and backgrounds who can all come together in the shared courtyard.

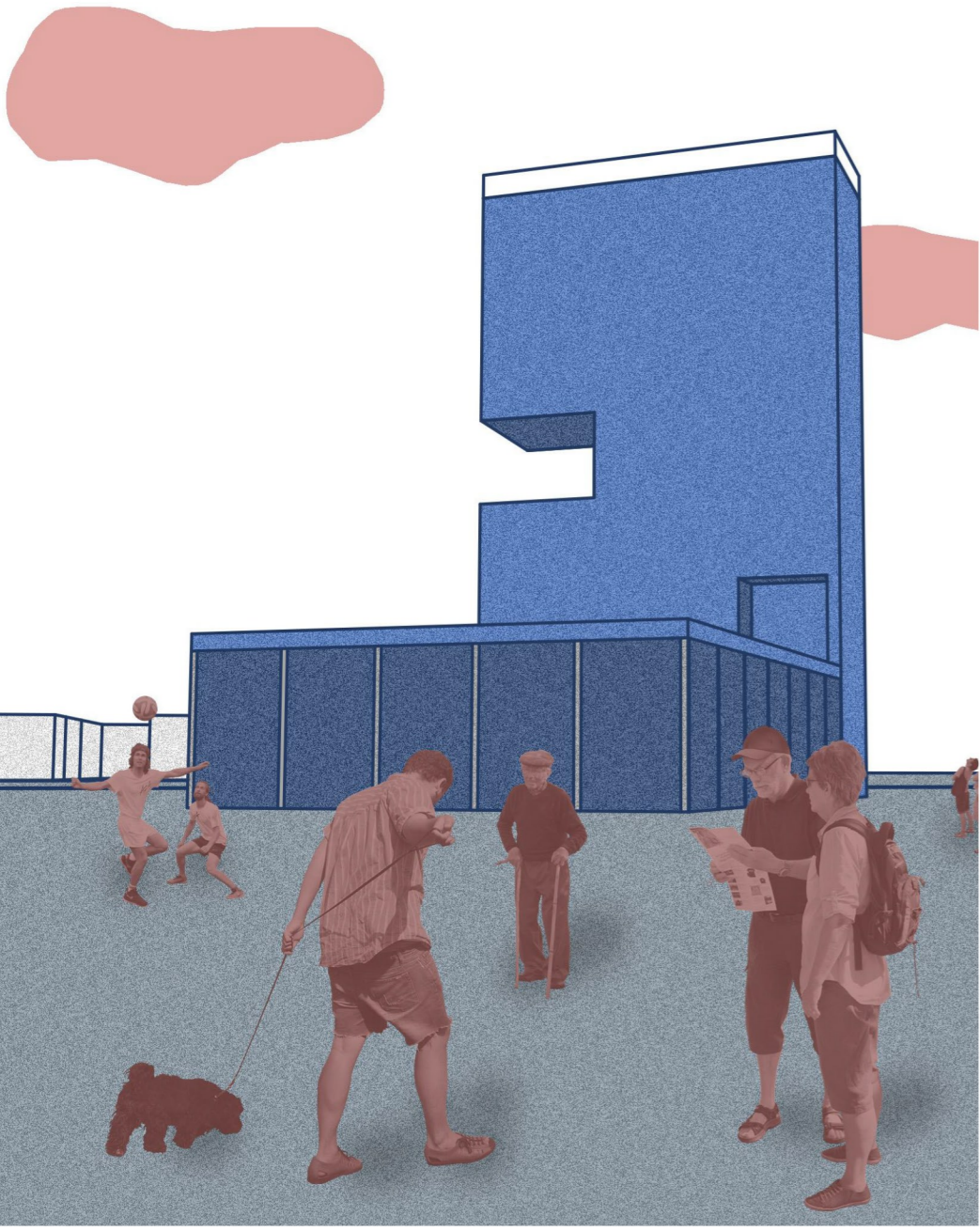

VIEWPOINT



FOOTBRIDGE: "GASTRONOMY"



VOLLEYBALL-COURTS

