

moor resting



The campsite consists of several clusters, each equipped with their own pavilion. These contain the necessary sanitary facilities and a communal kitchen. Cars are banded in the heart of the clusters and led around them to guarantee a carefree and relaxing environment. The clusters are gathered around a common calm green space. In the north, an informative and eating kiosk is located along with a play and sports opportunity. Furthermore, a car park and the original skate park can be found.



camping floor plan | section  
M 1:500

moor bad

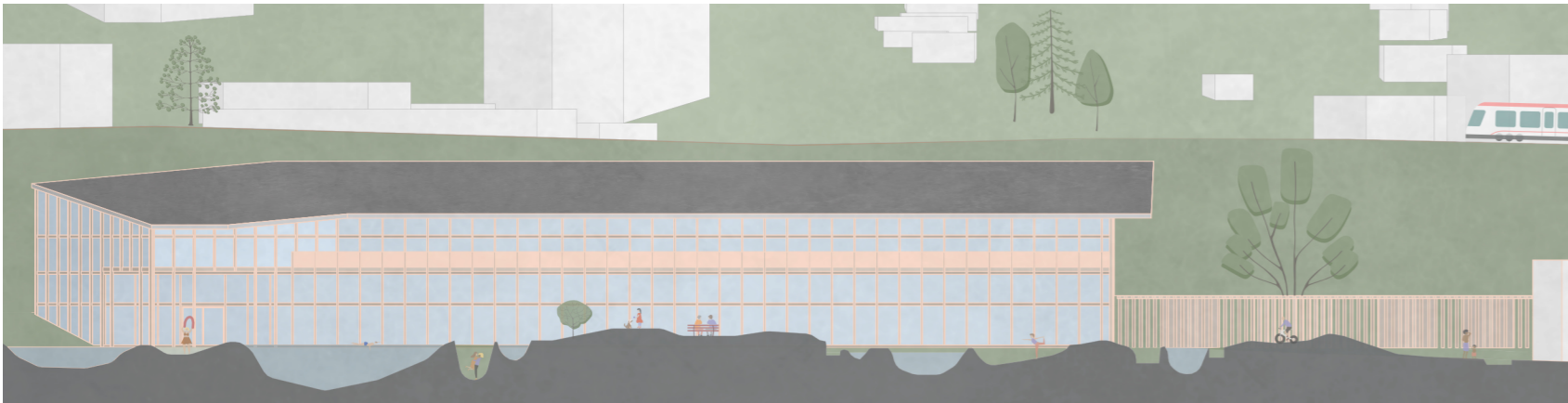

The extension to the ARDESIA thermal baths includes a sport swimming pool and is connected to a wooden pergola. This forms a direct link between the original thermal baths and its extension for bathing guests on the east side. The west side is publicly accessible and contains changing rooms for visitors of the Moorpark. The Moorpark is a place of experience which has small pools and lawns in the form of islands. They are crossed with paths that change in height and width to reflect a sense of the swamp.

therme entrance

therme floor plan | section  
M 1:500

moor care



The medical care centre (MCC) forms the link between the Altmarkt (Market) and the thermal baths. With medical functions, it is strongly associated to the thermal baths, but also beneficial for residents. The old bathtubs who are placed in the garden and used as planter or bench, refer to the activities in the former building (Kurhaus – spa house). Through the pergola, you are led further into the park. The round, wooden pavilion offers a soothing environment for meditation or relaxing where water takes a central stage.

MCC lake site

MCC floor plan | section  
M 1:500