

Siteplan 1:2500

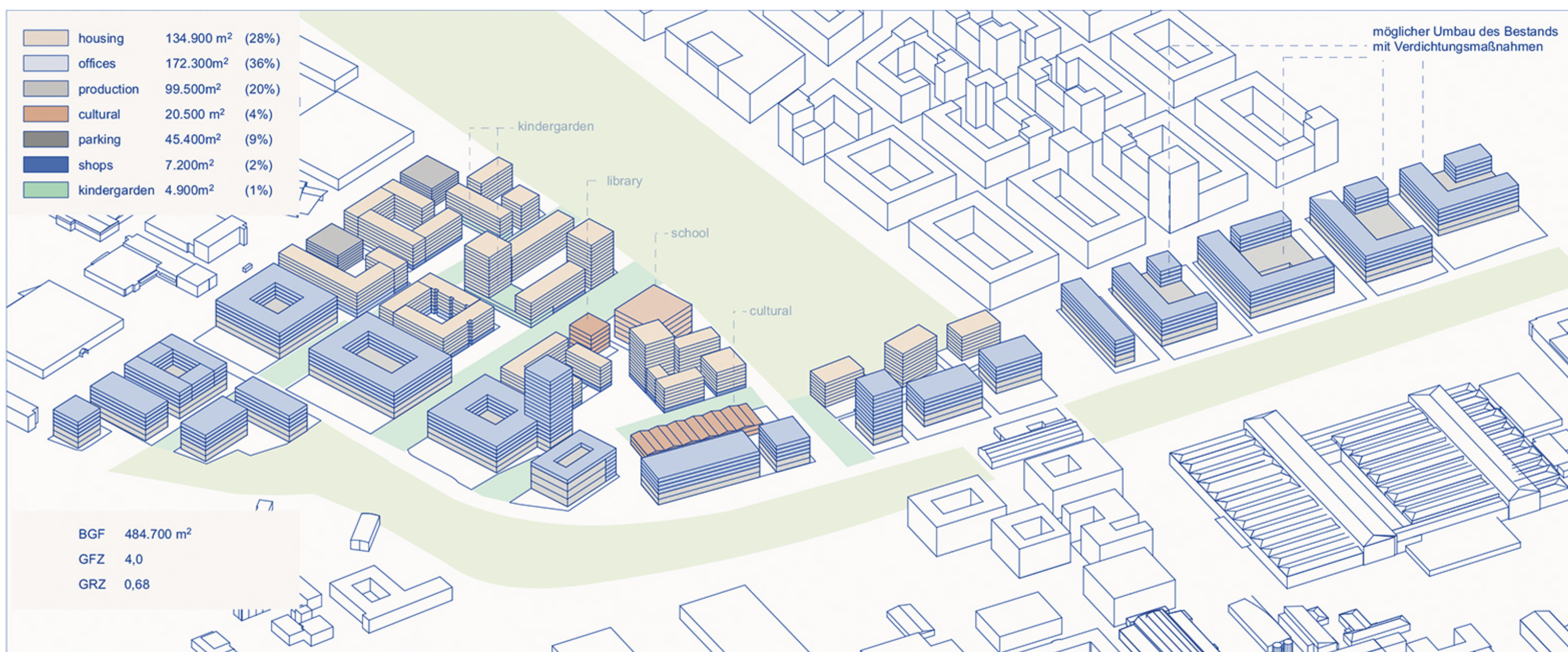

Land Use Plan



1. Four zones are developed and are oriented in shape and scale to their context.



2. The warehouses are located on Maria-Probst-Straße, along which the delivery will be made.

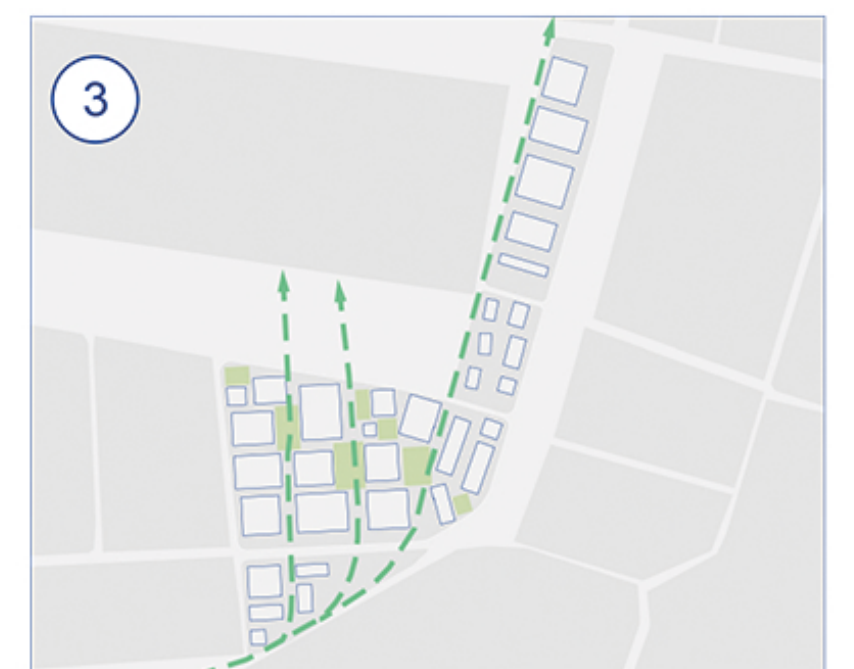

3. The existing tracks are further knitted into green strips and crossed by a sequence of squares.



4. The square sequence is marked by high points. A bicycle path and public uses in its corners support its urban character.

RULES FOR THE ARRANGEMENT OF THE HALLS



1. LOGISTICAL BACKBONE: Halls may only be located along Maria-Probst-Str. and delivered via logistic yards along this street.

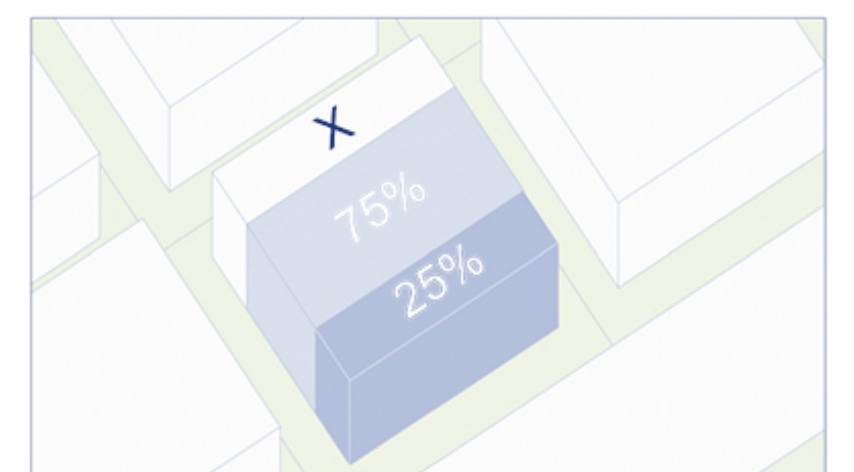

2. HALL PLUS X: Min. 25% and max. 75% of the permitted area of the building plots on M.-Probst-Str. are to be used for halls.

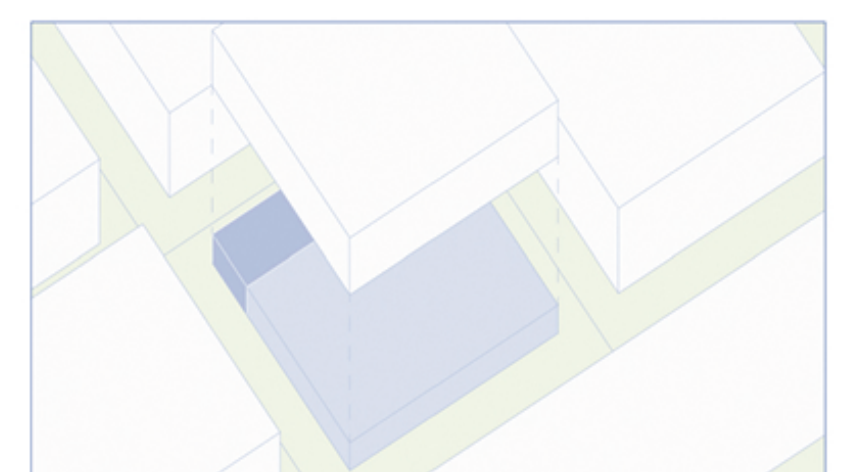

3. URBAN CORNERS: At least one corner of the plot must not be used as a hall. This corner must not be located on M.-Probst-Str.

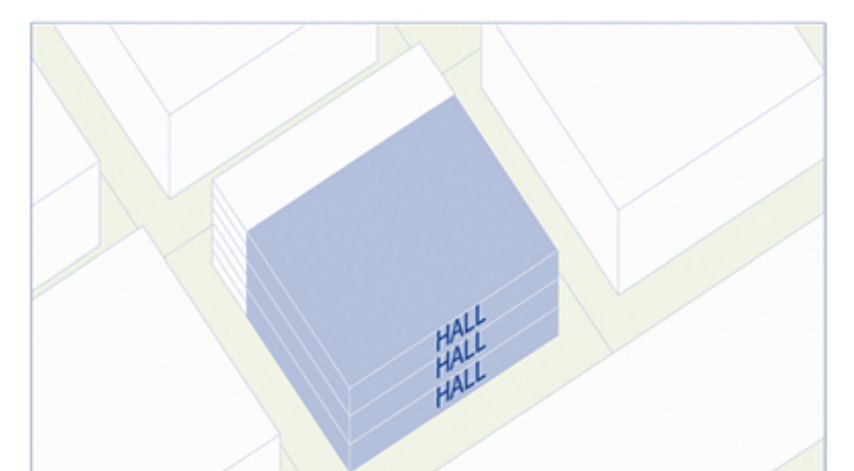

4. VERTICAL STORAGE: Halls may be stacked. Their maximum height must not exceed that of the other buildings on the site.