

revitalizes the neighborhood with a composition of fragments of the 8 groups and site.

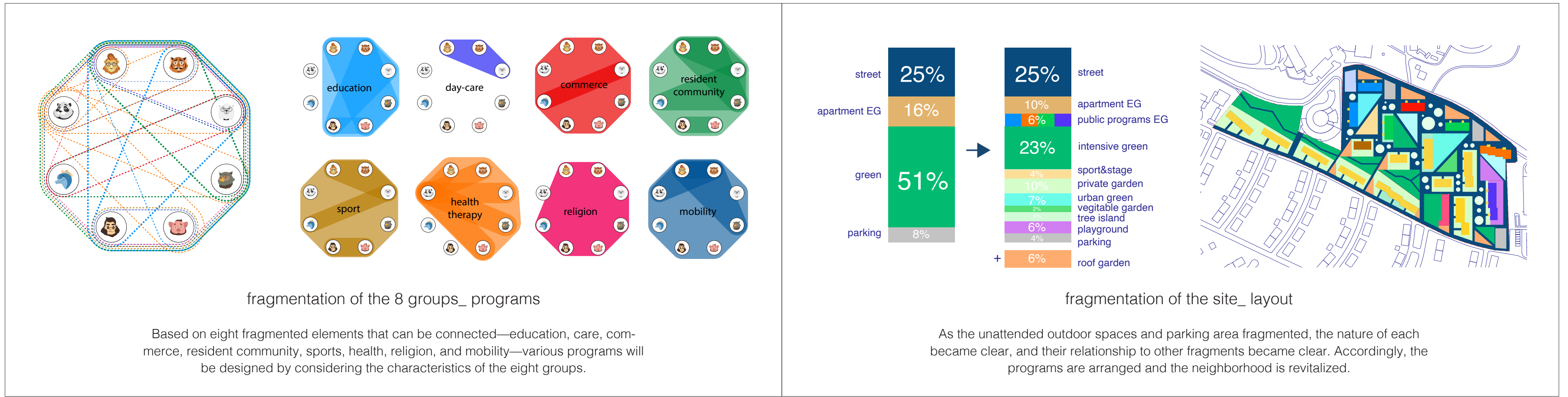

site strategies

25 fragment(s) as neighborhood scale

The pre-existing cut-off green spaces, underutilised parking areas, and disconnected ground-level residences form fragmented relationships with the surroundings. Based on the urban context, these fragmented spaces are reorganised along the public mobility axis Vitusstraße and the resident axis Adalbert-Stifter-Straße. The fragmented spaces, diversified through various programs, are reorganised along five axes to create a new neighbourhood appearance.

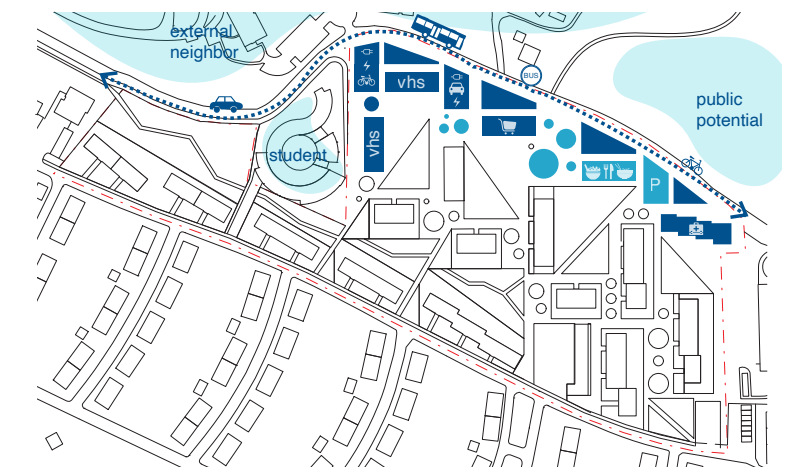

1-2 public axes

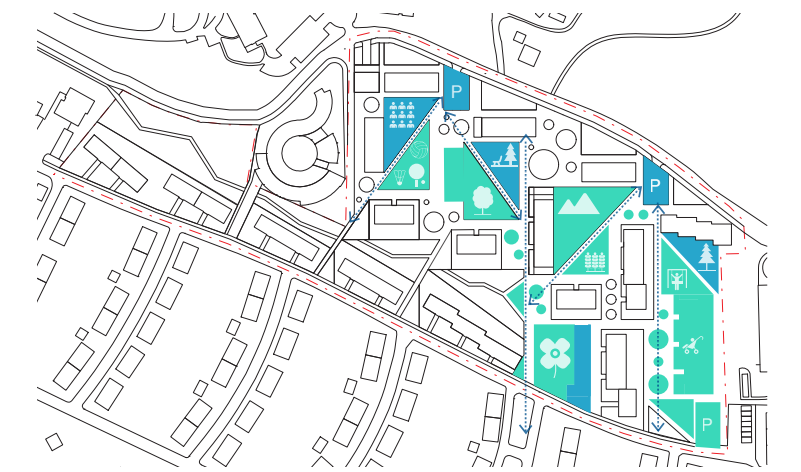

2-3 public & semi public axes



4-5 semi private & private axes

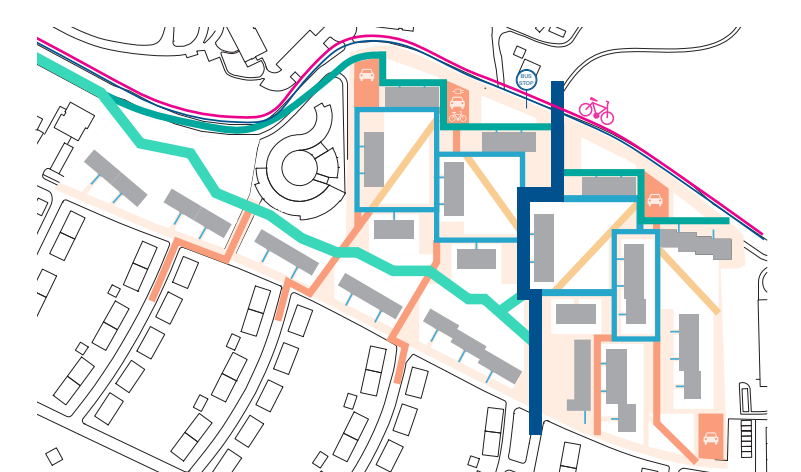

circulation system



rainwater reuse and solar energy



5 steps of development